



**Charles W. Woodward High School Project:
Phase 2: Work Session No. 4**

November 17, 2021



The Webinar Process...

This meeting is taking place as a Zoom **Webinar**.

- Camera and microphone access will be limited to Panelists.

The presentation will be followed by a brief Poll

- Please participate!

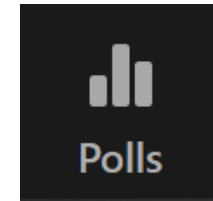

And

A Question and Answer Session.

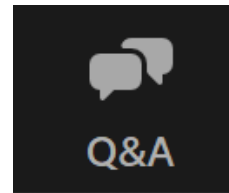

- Q&A Session will be held after the poll, please save questions for this section
- Please click on the Question & Answer Icon to type in your questions.
- A host will read your question and a panelist will respond, as time allows.
- For further questions, contact [Jonathan O Acosta@mcpsmd.org](mailto:Jonathan_O_Acosta@mcpsmd.org)
- This presentation will be posted on the MCPS Website

Thank you for coming!

Agenda

Welcome

I. Project History/Schedule

II. Phase 1 – Building

III. Phase 2 - Building Concept & Site Options

IV. Participant Poll

V. Question and Answer Session

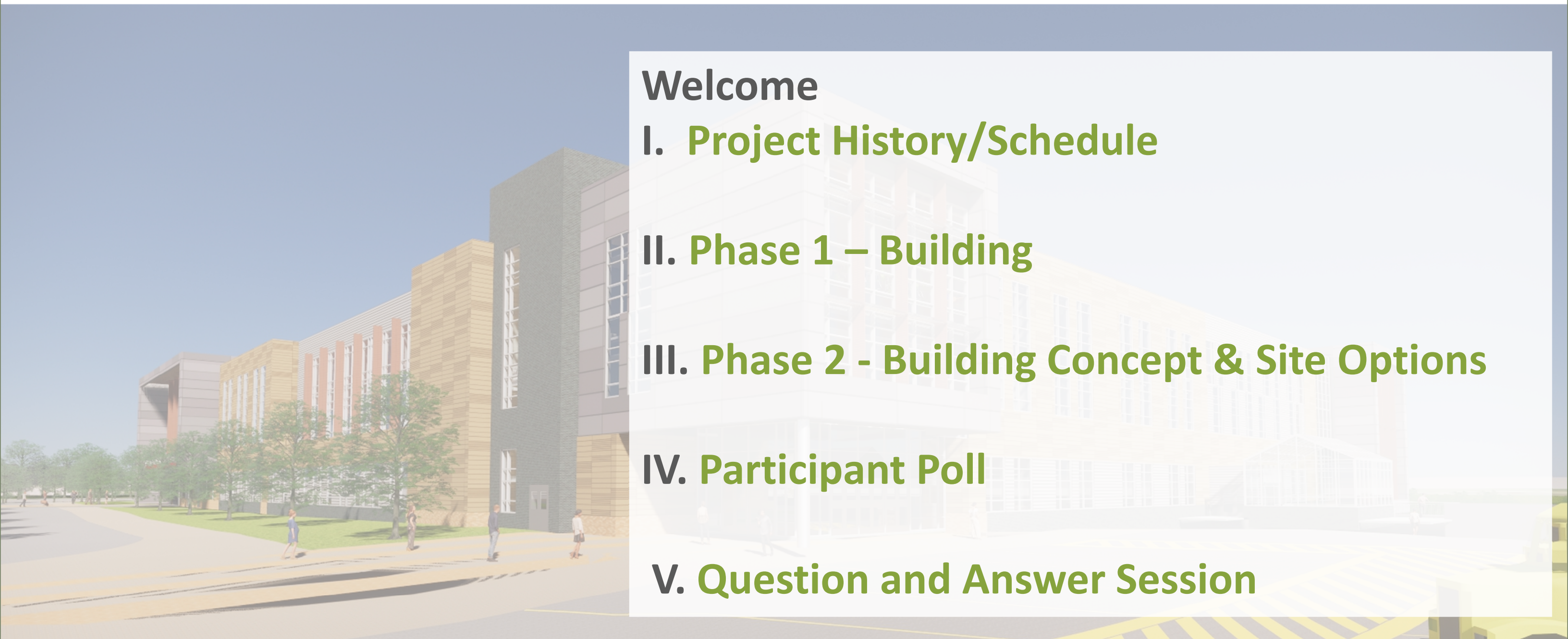

Project History

The purpose of the project is to provide a new Charles W. Woodward High School to relieve the overutilization in Walter Johnson High School Cluster and the Downcounty Consortium. The building will be used initially as a holding facility by Northwood High School from 2023 through 2025 and will serve 1800-2100 students with a program capacity for 2160 students.

Preliminary Enrollment at DCC High Schools (2021-2022):

School	Program Capacity	Enrollment	Available Space
Montgomery Blair HS	2866	3164	(298)
Albert Einstein HS	1633	1899	(266)
John F. Kennedy HS	1794	1791	3
Northwood HS	1508	1804	(296)
Wheaton HS	2234	2365	(131)
Total:	10,035	11,023	(988)

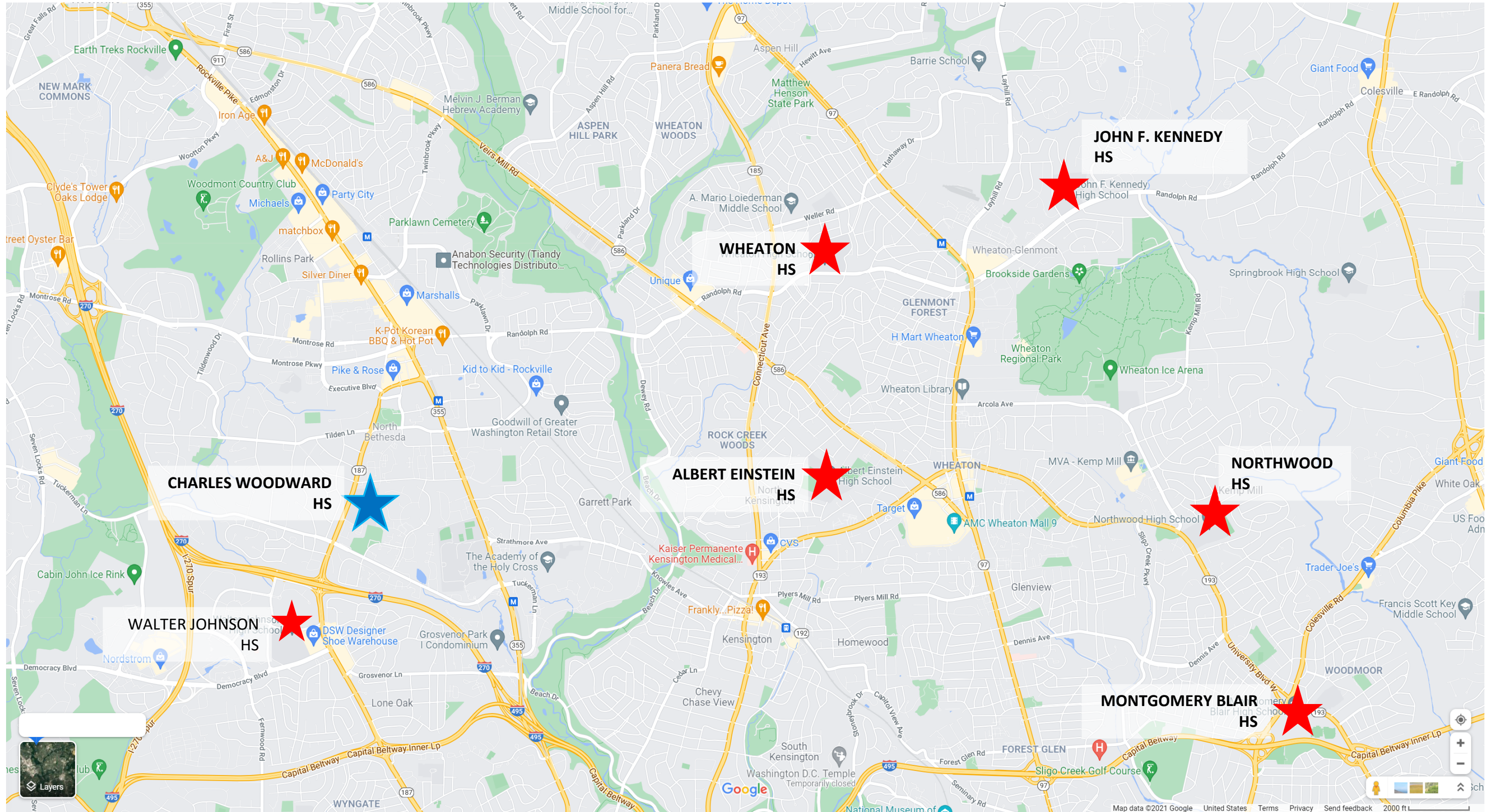

VICINITY MAP: Woodward High School and the Downcounty Consortium

Schedule

	 SCHOOL YEAR							
SCHOOL	2018-2019	2019-2020	2020-2021	2021-2022	2022-2023	2023-2024	2024-2025	2025-2026
TILDEN MS	Existing Tilden/ Woodward	Existing Tilden/ Woodward	New Tilden MS	New Tilden MS	New Tilden MS	New Tilden MS	New Tilden MS	New Tilden MS
NORTHWOOD HS	Existing Northwood HS	Existing Northwood HS	Existing Northwood HS	Existing Northwood HS	Existing Northwood HS	Holding School: Woodward Phase 1	Holding School: Woodward Phase 1	New Northwood HS
WOODWARD HS	WOODWARD PHASE I DESIGN		WOODWARD PHASE I CONSTRUCTION			WOODWARD PHASE II CONSTRUCTION		New Woodward HS
				WOODWARD PHASE II DESIGN				

Where we are



Phase 1: Site Plan

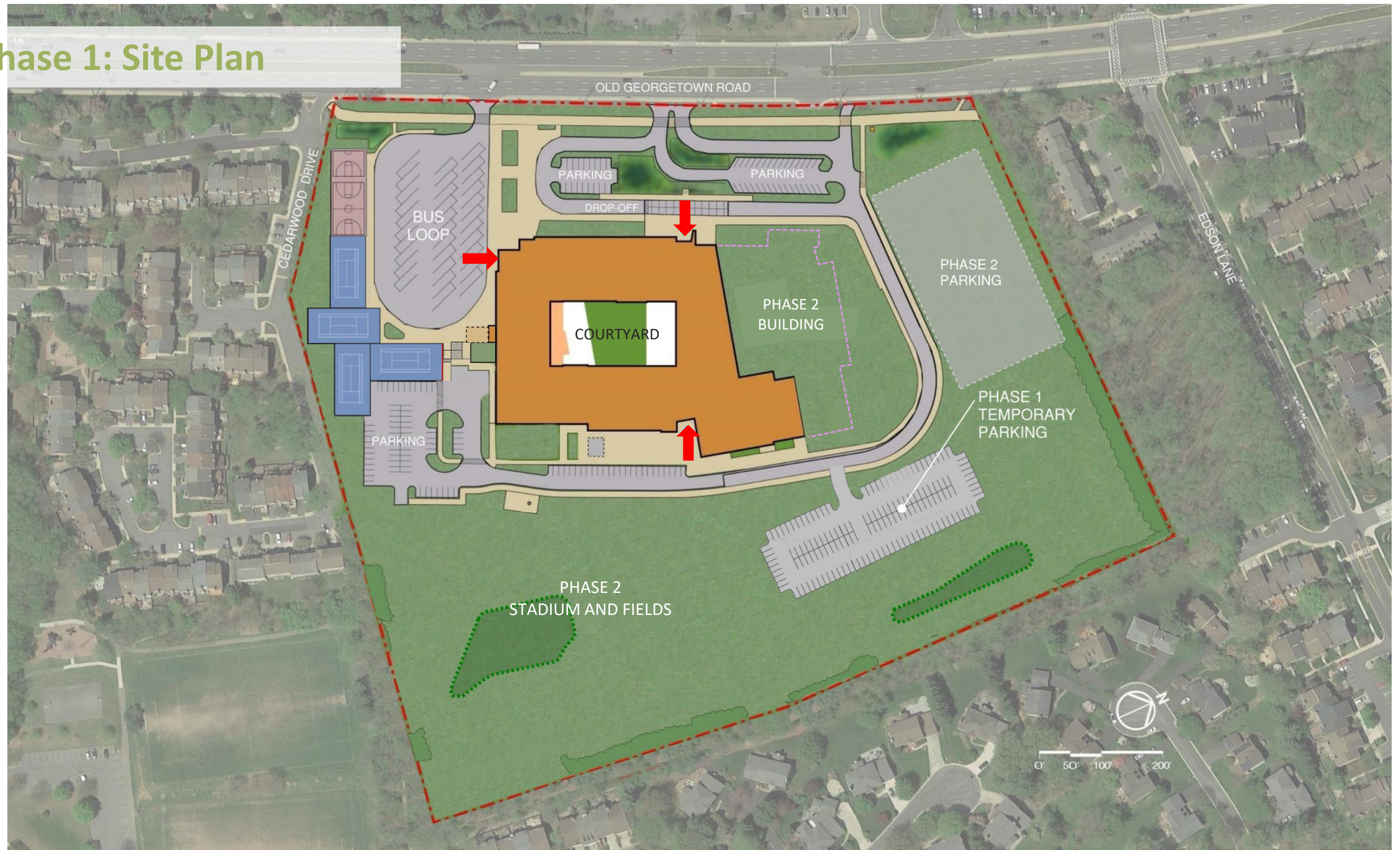

Phase 1: Building Perspectives

West



Phase 1: Building Perspectives



Phase 2 Building Program



Phase 2 Building Concept: Graphic Program

PERFORMING ARTS SPACES

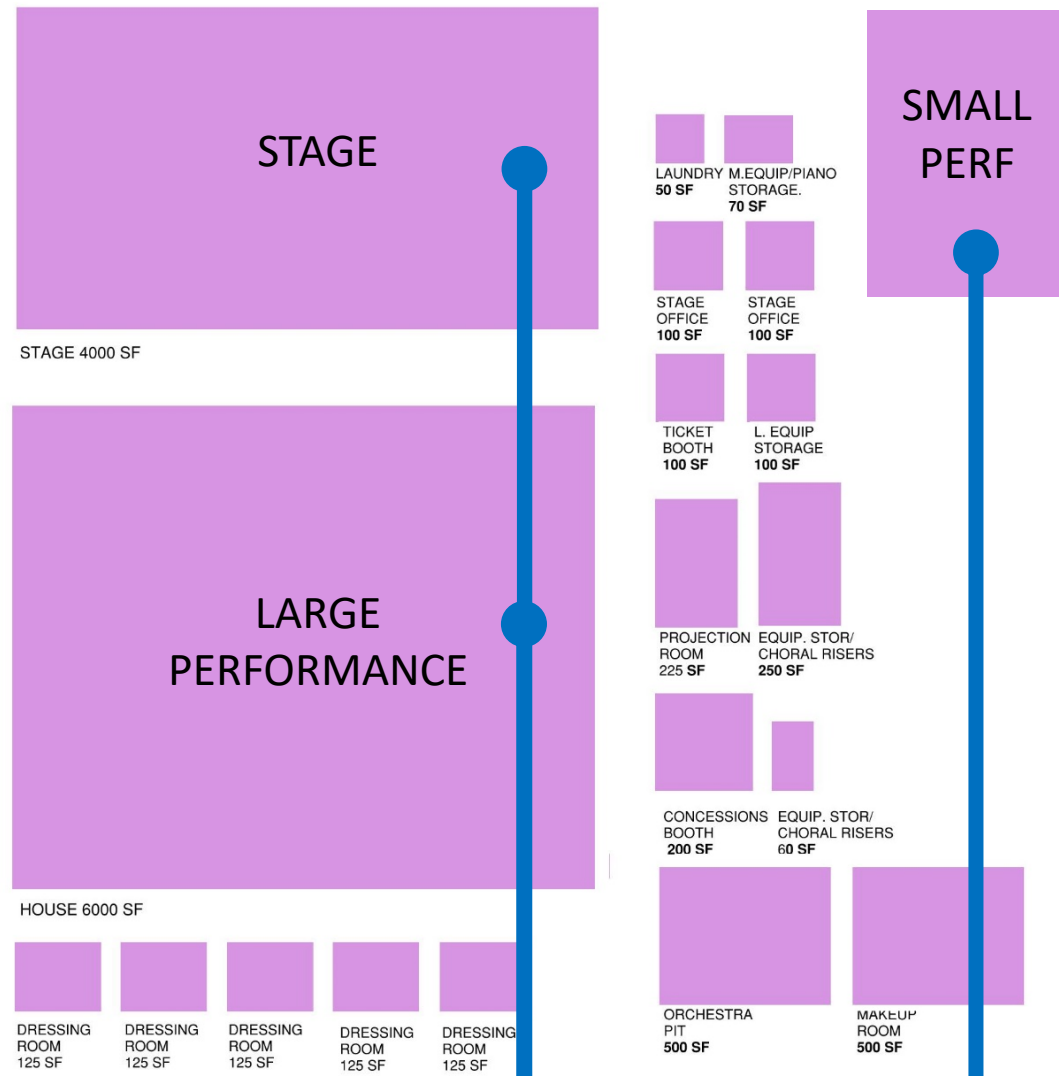

ART CORE SPECIALTY SPACES - MUSIC

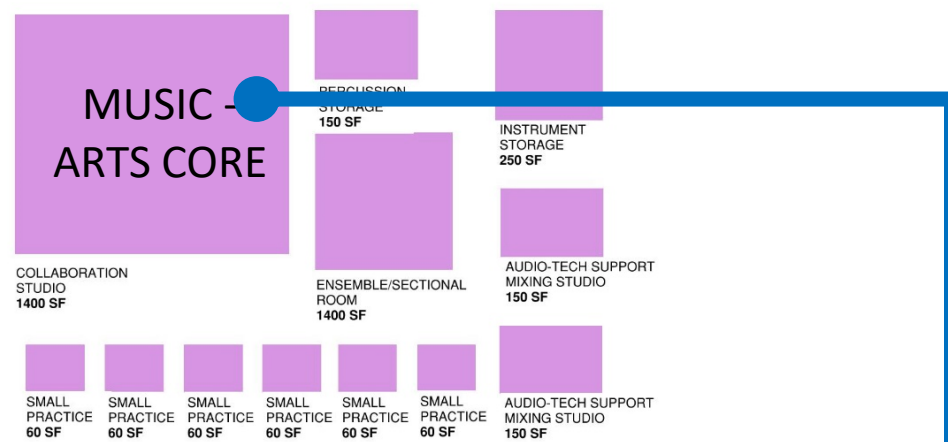

ART CORE SPECIALTY SPACES - ART

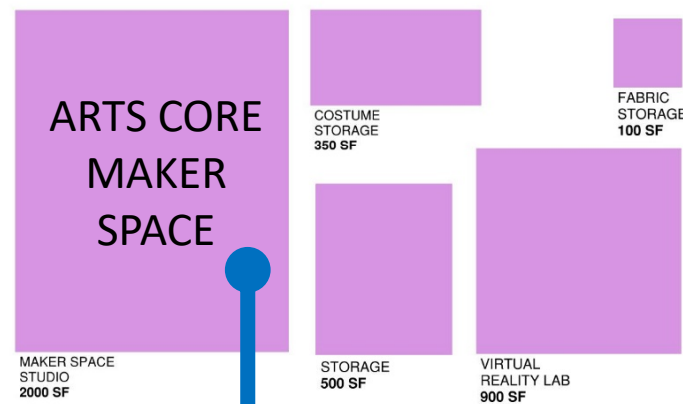

PHYSICAL EDUCATION

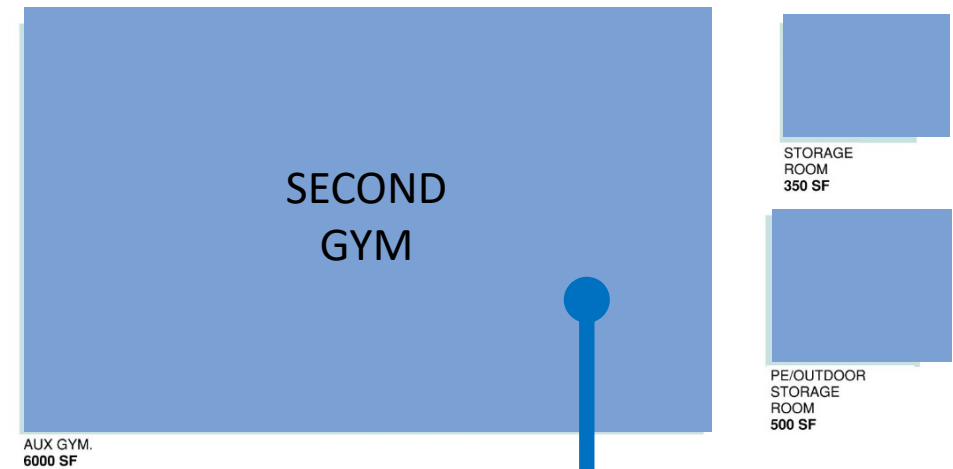

Phase 2 Site Options: Our Goals...

- Minimize retaining wall height and length where possible.



- Provide emergency and ADA access to each of the fields

- Maintain regulation sizes of site amenities/fields

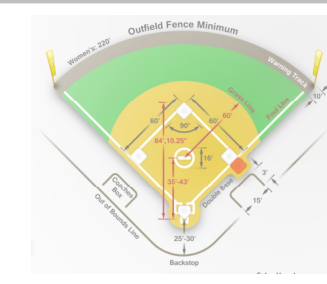

- Minimize impact on Edson Lane property



MCPS Stadiums



Poolsville High School



Northwood High School



Sherwood High School

- Examples of both single and double-sided grandstands
- Proximity to residences



Albert Einstein High School



Bethesda Chevy Chase High School

QUESTIONS?

Thank you!